

## OCS/WSS MxN FAU

### Description

Vlink's OCS/WSS Fiber Array Units (FAUs) are manufactured using high-precision, high-density V-Groove substrates, resulting in optimal fiber core positioning accuracy and superior polished surfaces. Our FAUs offer a comprehensive range of features, including low insertion loss, high return loss, compact size, and hermetic sealing, making them adaptable to diverse customer requirements.

### Key Features

- Non-Linear and Low Insertion Loss
- High Density
- Hermetic Sealing

### Applications

- OCS (Optical Circuit Switch)
- WSS (Wavelength Selective Switch)

### Specifications

| Parameter              | Unit                  | Value                                |
|------------------------|-----------------------|--------------------------------------|
| Wavelength             | nm                    | 1310, 1480, 1550 or 1620             |
| Channel Count          |                       | 9/18/24/36/40/44/72/128/256/400/1000 |
| Typ. Insertion Loss    | dB                    | 0.15                                 |
| Max. Insertion Loss    | dB                    | 0.50                                 |
| Max. Pitch Error       | μm                    | 1.5                                  |
| Fiber Length Tolerance | %                     | ± 10 or Specify                      |
| Operating Temperature  | °C                    | - 5 to + 70                          |
| Storage Temperature    | °C                    | - 40 to + 85                         |
| Max. Helium Leak Rate  | Pa. m <sup>3</sup> /s | 1.0 × 10 <sup>-8</sup>               |

### Package Dimensions

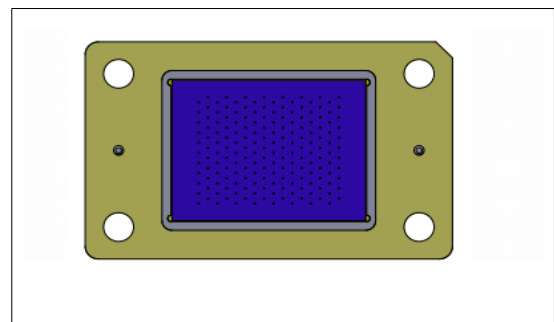
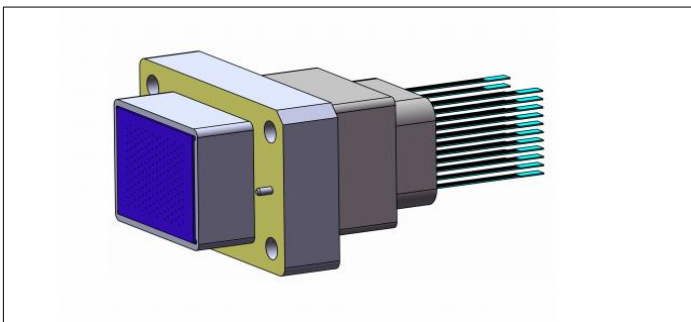

### Ordering Information

**FA-①①-②②-③-④-⑤-⑥-⑦-⑧-⑨**

①①: Fiber Count  
 01 - 24 Channel  
 02 - 400 Channel  
 SS - Specify

②②: AR-Coating  
 NO - NO Coating  
 25 - R < 0.25% @ 1520 - 1630 nm  
 SS - Specify

③: Material Type  
 1 - Borosilicate  
 2 - Fused Silica  
 3 - Silicon  
 S - Specify

④: Port Spacing

1 - 250  $\mu\text{m}$

2 - 500  $\mu\text{m}$

3 - 1000  $\mu\text{m}$

S - Specify

⑤: Polishing Angle

1 - 0°

2 - 8°

S - Specify

⑥: Fiber Length

1 - 1 m

S - Specify

⑦: Fiber Type

F - SM Fiber

S - Specify

⑧: FAU Thickness

1 - 3 mm

S - Specify

⑨: Connector Type

1 - FC/UPC

2 - FC/APC

3 - SC/UPC

4 - SC/APC

5 - LC/UPC

6 - LC/APC

N - None

S - Specify